

## Pixelator Mini



### Features

- 8 Pixel Link (RJ -45) data output ports
- 16 Universe Ethernet to Plink
- Easy to setup & update through any web browser
- Supports following DMX over Ethernet protocols:
  - Art-Net 1/2/3
  - Streaming ACN (sACN)
  - Kling-net
  - ESP
- 1 RJ45 Ethercon connector (10/100 Mbps)
- Static or Dynamic (DHCP) IP configuration (DHCP by default)
- Compatible with ENTTEC Plink Injectors
- Pixel Grouping is configurable for each Pixel Link port. (1 to 340) for RGB and (1 to 256) for RGBW
- Each Pixel Link output can be assigned up to 2 Ethernet Universes.
- Pixel Ordering is configurable for each Pixel Link port. RGB modes allow 3 slot mapping, and RGBW modes allows 4 slot mapping

### Safety

- Do not expose the unit to rain or moisture, doing this will void the warranty
- Do not remove the cover, there are no serviceable parts inside
- This unit is intended for indoor use only

### Physical Dimensions (mm)

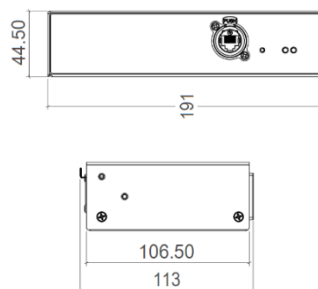

### Ordering Information

PN	Description
70066	Pixelator Mini
73546	Plink Injector 5V
73544	Plink Injector 12V - 24V

### LED Protocols Supported

For supported protocols, please refer to support page:  
[https://www.enttec.com/support/supported\\_led\\_pixel\\_protocols/](https://www.enttec.com/support/supported_led_pixel_protocols/)

#### Notes:

We cannot claim to support other led protocols similar to the ones supported by Pixelator Mini. If you happen to find one that works, and is not listed, please let us know, so we can update our documentation

Distributor:



Phone: 407-857-8770

Fax: 407-857-8771

Email: sales@techni-lux.com

www.techni-lux.com

## Specifications

Item	Value
<b>PSU Input Voltage</b>	85 – 264V AC
<b>PSU Input Frequency</b>	47 - 63 Hz
<b>Weight</b>	1.65 lbs. / 0.8 Kg
<b>Shipped weight</b>	3.19 lbs. / 1.153 Kg
<b>Length</b>	7.52" / 191mm
<b>Width</b>	4.19" / 106.5mm
<b>Height</b>	1.75" / 44.5mm
<b>Output Protocol</b>	For supported protocols, please refer to support page: <a href="https://www.enttec.com/support/supported-led-pixel-protocols/">https://www.enttec.com/support/supported-led-pixel-protocols/</a>
<b>Input Protocol</b>	Art-Net, sACN, Kling-net or ESP
<b>Op Environment</b>	0° -50°C
<b>Relative humidity</b>	5%-95% non-condensing environment
<b>Connectors</b>	8x RJ45 Plink output 1x IEC power connector 1x RJ45 Ethercon connector

Note: Connected fixtures for illustration purpose only. Only one protocol active at a time.

## Accessories and Recommended Products

PN	Description
<b>70581-ARC</b>	ENTTEC LED Mapper Software (ELM) Architectural (512 Universes)
<b>70581-PRO</b>	ENTTEC LED Mapper Software (ELM) Professional (96 Universes)
<b>70581-STU</b>	ENTTEC LED Mapper Software (ELM) Standard (16 Universes)
<b>9PDOT (1-8)</b>	HI-RES SMART RGB PIXEL DOTS
<b>8PL60-F-12</b>	RGB PIXEL TAPE 60 LEDS/METER 12V - 5M Roll
<b>8PL30-F</b>	RGB PIXEL TAPE 30 LEDS/METER 5V - 5M Roll
<b>8PL60-F</b>	RGB PIXEL TAPE 60 LEDS/METER 5V - 5M Roll
<b>8PL144-2</b>	RGB PIXEL TAPE 144 LEDS/METER 5V - 2M Roll
<b>8PX60-4</b>	RGBW PIXEL TAPE 60 LEDS/METER 5V - 4M Roll
<b>8PXW60-4-B</b>	RGBW PIXEL TAPE 60 LEDS/METER 5V - 4M Roll Black No Coating
<b>8PX30-F</b>	RGBW PIXEL TAPE 30 LEDS/METER 5V - 5M Roll
<b>8PW60-F</b>	WWA (CTA+AMBER) PIXEL TAPE 60 LEDS/METER 5V - 5M Roll
<b>8PW30-F</b>	WWA (CTA+AMBER) PIXEL TAPE 30 LEDS/METER 5V - 5M Roll
<b>8P60-5-B</b>	Pixel tape 60 LEDS/METER 5V - 5M Roll Black No Coating

## Wiring Diagrams

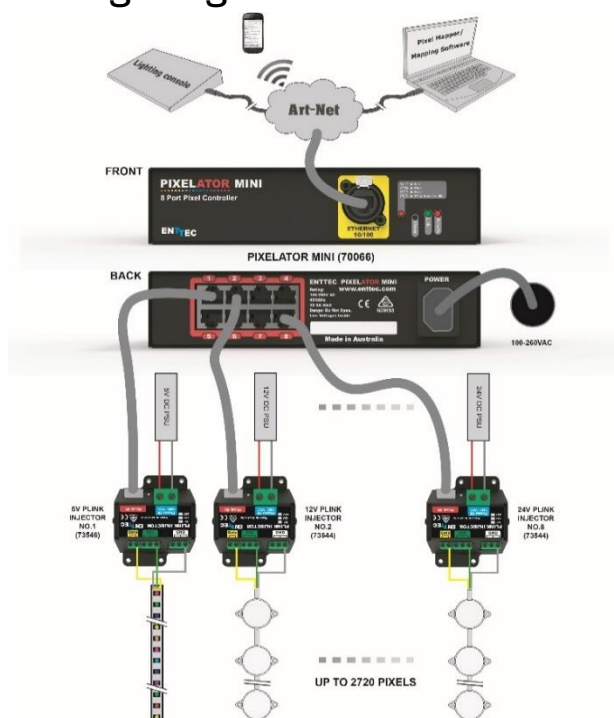

Due to continuous improvements and innovations of all ENTTEC products, specifications and features are subject to change without notice.

# enttec.com

MELBOURNE AUS / LONDON UK / RALEIGH-DURHAM USA